



Peoria Crossing

9350 W. Northern Avenue
Glendale, AZ 83505

Center Type:
GLA: 238,004

Leasing Contact

Chrystelle Shanks

(888) 343-0673

cshanks@dclcmgmt.com

PROPERTY HIGHLIGHTS

- High-traffic power center: conveniently accessible from major interstates and located within the fast-growing community of Glendale, AZ.
- Prime regional positioning: minutes from major tourist destinations including Desert Diamond Casino and the Westgate Entertainment District.
- Strong national anchor lineup: featuring Target, Kohl's, Ulta, Michaels, and Ross.
- Exceptional retail presence: offering strong visibility and a compelling mix of anchors that drive steady customer activity.

DEMOGRAPHICS

	1M	3M	5M
POPULATION	10,308	93,412	338,656
HOUSEHOLDS	3,706	34,243	118,252
AVG HH INCOME	\$118,644	\$93,835	\$92,324

MAJOR TENANTS



KOHL'S

Michaels



Peoria Crossing

Contact:
CHRISTELLE SHANKS

(888) 343-0673
cshanks@dclcmgmt.com

● Available ● Coming Available

AVAILABLE SPACES

7 4,042 SF

COMING AVAILABLE

12 1,500 SF

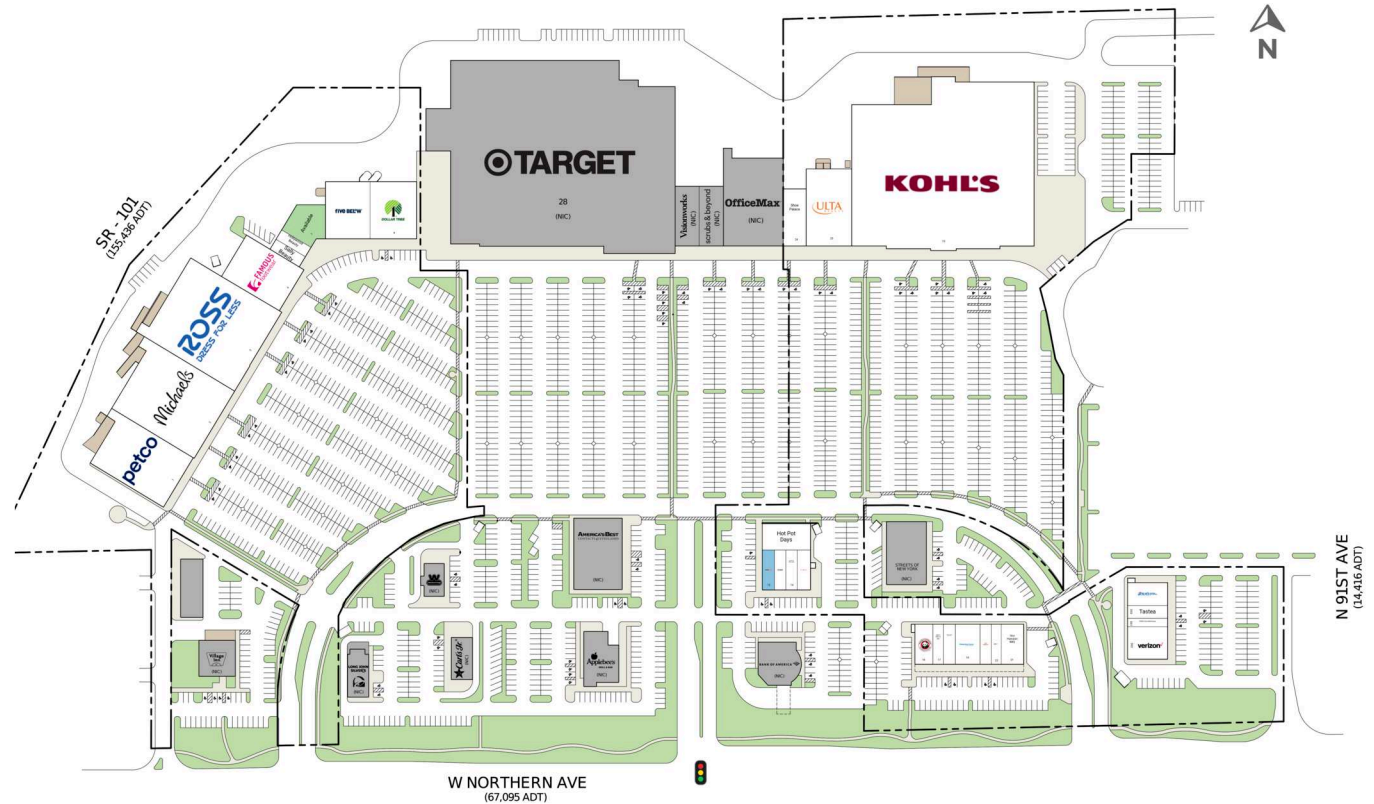

CURRENT TENANTS

D01	DMND Kutz Barbershop	1,050 SF	6	Hollywood Beauty	1,269 SF	17	Julie's Nails & Spa	1,300 SF
D02	Verizon Wireless	4,000 SF	8	Five Below	8,000 SF	18	Phoenix Laser & Rejuvenation	1,474 SF
D03	Tastea	1,575 SF	9	Dollar Tree	8,000 SF	19	Bright Now! Dental	3,034 SF
D06	Leslie's Pool Supplies	2,800 SF	10	Kohl's	88,408 SF	20	Quiznos Sub	1,400 SF
1	Petco	15,216 SF	11	Hot Pot Days	4,500 SF	21	Ono Hawaiian BBQ	2,705 SF
2	Michaels	24,063 SF	12	GameStop	1,500 SF	22	Supercuts	1,202 SF
3	Ross Dress for Less	30,171 SF	13	Great Clips	1,405 SF	24	Shoe Palace	4,050 SF
4	Famous Footwear	10,030 SF	14	Southwest Title Loans	1,412 SF	25	ULTA Beauty	10,793 SF
5	Sally Beauty	1,200 SF	15	T-Mobile	1,200 SF			
			16	Panda Express	2,205 SF			

This site plan indicates the general layout of the shopping center and is not a warranty, representation, or agreement on the part of the landlord that the shopping center will be exactly as depicted herein.